



# Wexis



## Wexis Grossing Workstation PW900

The main body of PW900 Grossing Workstation uses SUS-304 stainless steel with thickness of 1.2MM and the work bench uses SUS-316 stainless steel with thickness of 1.5MM.

Draught fan and pipes were made of PP material and have strong corrosion-proof & aging-resistant property with blast capacity of 1200 M<sup>3</sup>/hour.

This product adopts downdraft and backdraft ventilation design to adsorb odor and discharge hazardous gas effectively, thus protects health of work staff.

Low-noise and high-powered centrifugal fan to discharge air, and can be connected with pipes to discharge air outdoor.

Tool shelf with magnetic adhesion function which adheres metal grossing devices and dissection devices to its surface for convenient use

40W Fluorescent lamp and sterilamp offers effective illumination and sterilization.



# Installation instruction for Grossing workstation

Installation process sticks to the following step :

Step 1: Sewer (water outlet  $\Phi 40$ , water inlet  $\Phi 15$ )

Step2: Electric wire (incoming line 2.5M)

Step 3: Draught fan module

Step 4: Ventilation pipe

Note: Line-in voltage, 50Hz

## Ordering Number

Item No.:	900-00-00
Model No.:	PW900
Product Name:	Grossing Workstation PW900
Dimensions(L*W*H):	1800mm*850mm*2200mm
Voltage:	220V~ 50Hz

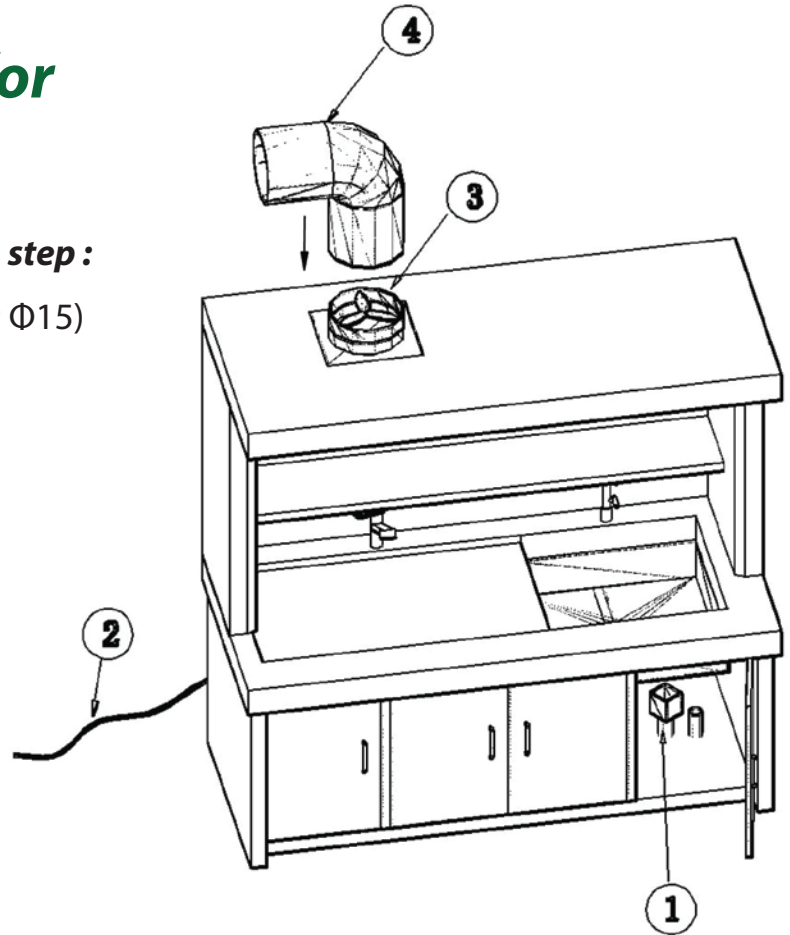

## Wexis instrument series



Specimen Freezer SF736



Air Purifier (Ceiling type)



Air Purifier (Mobile type)

\*Image is for illustration purposes only.

### Wexis Group Limited

Address: Unit 1611, 16/F, Yuen Long Trading Centre,  
33 Wang Yip Street, Yuen Long, NT, Hong Kong

Tel: 852-2567 2882

Fax: 852-2567 6333

E-mail: sales@wexisgp.com

www.wexisgp.com

